

BUREAU OF ALCOHOL BEVERAGES AND LOTTERY OPERATIONS
DIVISION OF LIQUOR LICENSING AND ENFORCEMENT
 8 STATE HOUSE STATION, AUGUSTA, ME 04333-0008
 10 WATER STREET, HALLOWELL, ME 04347
 TEL: (207) 624-7220 FAX: (207) 287-3434
 EMAIL INQUIRIES: MAINELIQUOR@MAINE.GOV

DIVISION USE ONLY	
License No:	
Class:	By:
Deposit Date:	
Amt. Deposited:	
Cash Ck Mo:	

NEW application: Yes No

PRESENT LICENSE EXPIRES _____

INDICATE TYPE OF PRIVILEGE: MALT VINOUS SPIRITUOUS

INDICATE TYPE OF LICENSE:

- RESTAURANT (Class I,II,III,IV) RESTAURANT/LOUNGE (Class XI) CLASS A LOUNGE (Class X)
 HOTEL (Class I,II,III,IV) HOTEL NO FOOD (Class I-A)
 CLUB w/o Catering (Class V) CLUB with CATERING (Class I) GOLF COURSE (Class I,II,III,IV)
 TAVERN (Class IV) QUALIFIED CATERING OTHER: _____

REFER TO PAGE 3 FOR FEE SCHEDULE

ALL QUESTIONS MUST BE ANSWERED IN FULL

Corporation Name: FALMOUTH PREMIUM CINEMAS LLC			Business Name (D/B/A)		
APPLICANT(S) –(Sole Proprietor)		DOB:	Physical Location: 206 U.S. ROUTE 1		
		DOB:	City/Town FALMOUTH	State ME	Zip Code 04105
Address 55 CAMBRIDGE PARKWAY SUITE 200			Mailing Address 206 U.S. ROUTE 1		
City/Town CAMBRIDGE	State MA	Zip Code 02142	City/Town FALMOUTH	State ME	Zip Code 04105
Telephone Number 617 499 2700	Fax Number 617 679 0800	Business Telephone Number 207 536 7167		Fax Number 207 536 7630	
Federal I.D. # 01-0523764			Seller Certificate #: or Sales Tax #: 1178853		
Email Address: Please Print falmouth@flagshipcinemas.com			Website: www.flagshipcinemas.com		

If business is NEW or under new ownership, indicate starting date: 7/13/16

Requested inspection date: _____ Business hours: 9:30AM-10:30PM

PROPOSED BAR HOURS:
MON-FRI 6:30-9:30PM
SAT/SUN/HOLIDAYS 1:00-9:30PM

1. If premise is a Hotel or Bed & Breakfast, indicate number of rooms available for transient guests: _____
 2. State amount of gross income from period of last license: ROOMS \$ _____ FOOD \$ _____ LIQUOR \$ _____

3. Is applicant a corporation, limited liability company or limited partnership? YES NO

If Yes, please complete the Corporate Information required for Business Entities who are licensees.

4. Do you permit dancing or entertainment on the licensed premises? YES NO

5. If manager is to be employed, give name: ASHLEY TAYLOR

6. Business records are located at: 206 U.S. ROUTE 1, FALMOUTH ME 04105 & 55 CAMBRIDGE PKWY STE 200 CAMBRIDGE MA 02142

7. Is/are applicants(s) citizens of the United States? YES NO

8. Is/are applicant(s) residents of the State of Maine? YES NO

9. List name, date of birth, and place of birth for all applicants, managers, and bar managers. Give maiden name, if married:
Use a separate sheet of paper if necessary.

Name in Full (Print Clearly)	DOB	Place of Birth
PLEASE SEE ATTACHED		

Residence address on all of the above for previous 5 years (Limit answer to city & state)

10. Has/have applicant(s) or manager ever been convicted of any violation of the law, other than minor traffic violations, of any State of the United States? YES NO

Name: _____ Date of Conviction: _____

Offense: _____ Location: _____

Disposition: _____ (use additional sheet(s) if necessary)

11. Will any law enforcement official benefit financially either directly or indirectly in your license, if issued?
Yes No If Yes, give name: _____

12. Has/have applicant(s) formerly held a Maine liquor license? YES NO

13. Does/do applicant(s) own the premises? Yes No If No give name and address of owner: NATT ORNE
FORESIDE PLACE LLC 5 MILK STREET 3RD FLOOR PORTLAND ME 04101

14. Describe in detail the premises to be licensed: (On Premise Diagram Required) LUXURY TEN SCREEN MOVIE
THEATER W/SELF-SERVE SODA, ALL DIGITAL PROJECTION, SIGNAGE, ELECTRIC RECLINERS, KIOSKS FOR

15. Does/do applicant(s) have all the necessary permits required by the State Department of Human Services? ONLINE TICKET
REDEMPTION
YES NO Applied for: _____

16. What is the distance from the premises to the NEAREST school, school dormitory, church, chapel or parish house, measured from the main entrance of the premises to the main entrance of the school, school dormitory, church, chapel or parish house by the ordinary course of travel? 1.1 MILES Which of the above is nearest? SCHOOL

17. Have you received any assistance financially or otherwise (including any mortgages) from any source other than yourself in the establishment of your business? YES NO

If YES, give details: _____

The Division of Liquor Licensing & Enforcement is hereby authorized to obtain and examine all books, records and tax returns pertaining to the business, for which this liquor license is requested, and also such books, records and returns during the year in which any liquor license is in effect.

NOTE: "I understand that false statements made on this form are punishable by law. Knowingly supplying false information on this form is a Class D offense under the Criminal Code, punishable by confinement of up to one year or by monetary fine of up to \$2,000 or both."

Dated at: _____ on _____, 20____
Town/City, State Date

John J. Crowley
Signature of Applicant or Corporate Officer(s)
JOHN J. CROWLEY
Print Name

Please sign in blue ink

Signature of Applicant or Corporate Officer(s)

Print Name

Bureau of Alcoholic Beverages and Lottery Operations
 Division of Liquor Licensing & Enforcement
 8 State House Station, Augusta, ME 04333-0008
 10 Water Street, Hallowell, ME 04347
 Tel: (207) 624-7220 Fax: (207) 287-3434
 Email Inquiries: MaineLiquor@maine.gov

DIVISION USE ONLY	
<input type="checkbox"/>	Approved
<input type="checkbox"/>	Not Approved
BY:	

ON PREMISE DIAGRAM

In an effort to clearly define your license premise and the area that consumption and storage of liquor is allowed. The Division requires all applicants to submit a diagram of the premise to be licensed in addition to a completed license application.

Diagrams should be submitted on this form and should be as accurate as possible. Be sure to label the areas of your diagram including entrances, office area, kitchen, storage areas, dining rooms, lounges, function rooms, restrooms, decks and all areas that you are requesting approval from the Division for liquor consumption.

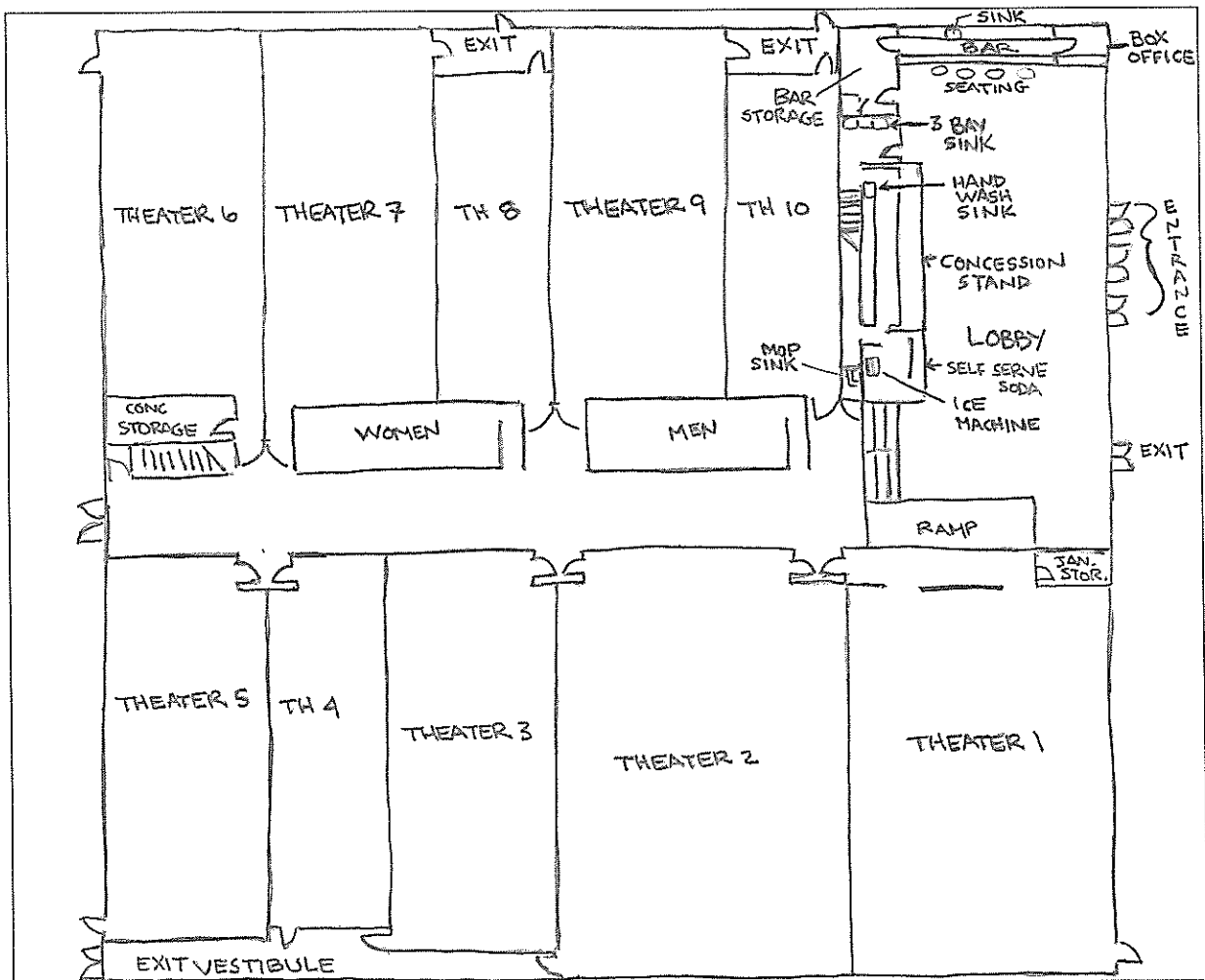

STATE OF MAINE

Dated at: _____, Maine _____
City/Town (County)

On: _____
Date

The undersigned being: Municipal Officers County Commissioners of the
 City Town Plantation Unincorporated Place of: _____, Maine

Hereby certify that we have given public notice on this application and held public hearing thereon as required by Section 653 Title 28A, Maine Revised Statutes and herby approve said application.

THIS APPROVAL EXPIRES IN 60 DAYS

NOTICE – SPECIAL ATTENTION

§653. Hearings; bureau review; appeal

1. Hearings. The municipal officers or, in the case of unincorporated places, the county commissioners of the county in which the unincorporated place is located, may hold a public hearing for the consideration of applications for new on-premises licenses and applications for transfer of location of existing on-premises licenses. The municipal officers or county commissioners may hold a public hearing for the consideration of requests for renewal of licenses, except that when an applicant has held a license for the prior 5 years and a complaint has not been filed against the applicant within that time, the applicant may request a waiver of the hearing.

A. The bureau shall prepare and supply application forms. [1993, c. 730, §27 (AMD).]

B. The municipal officers or the county commissioners, as the case may be, shall provide public notice of any hearing held under this section by causing a notice, at the applicant's prepaid expense, stating the name and place of hearing, to appear on at least 3 consecutive days before the date of hearing in a daily newspaper having general circulation in the municipality where the premises are located or one week before the date of the hearing in a weekly newspaper having general circulation in the municipality where the premises are located. [1995, c. 140, §4 (AMD).]

C. If the municipal officers or the county commissioners, as the case may be, fail to take final action on an application for a new on-premises license or transfer of the location of an existing on-premises license within 60 days of the filing of an application, the application is deemed approved and ready for action by the bureau. For purposes of this paragraph, the date of filing of the application is the date the application is received by the municipal officers or county commissioners. This paragraph applies to all applications pending before municipal officers or county commissioners as of the effective date of this paragraph as well as all applications filed on or after the effective date of this paragraph. This paragraph applies to an existing on-premises license that has been extended pending renewal. The municipal officers or the county commissioners shall take final action on an on-premises license that has been extended pending renewal within 120 days of the filing of the application. [2003, c. 213, §1 (AMD).]

D. If an application is approved by the municipal officers or the county commissioners but the bureau finds, after inspection of the premises and the records of the applicant, that the applicant does not qualify for the class of license applied for, the bureau shall notify the applicant of that fact in writing. The bureau shall give the applicant 30 days to file an amended application for the appropriate class of license, accompanied by any additional license fee, with the municipal officers or county commissioners, as the case may be. If the applicant fails to file an amended application within 30 days, the original application must be denied by the bureau. The bureau shall notify the applicant in writing of its decision to deny the application including the reasons for the denial and the rights of appeal of the applicant. [1995, c. 140, §5 (NEW).][2003, c. 213, §1 (AMD) .]

2. Findings. In granting or denying an application, the municipal officers or the county commissioners shall indicate the reasons for their decision and provide a copy to the applicant. A license may be denied on one or more of the following grounds:

- A. Conviction of the applicant of any Class A, Class B or Class C crime; [1987, c. 45, Pt. A, §4 (NEW).]
- B. Noncompliance of the licensed premises or its use with any local zoning ordinance or other land use ordinance not directly related to liquor control; [1987, c. 45, Pt. A, §4 (NEW).]
- C. Conditions of record such as waste disposal violations, health or safety violations or repeated parking or traffic violations on or in the vicinity of the licensed premises and caused by persons patronizing or employed by the licensed premises or other such conditions caused by persons patronizing or employed by the licensed premises that unreasonably disturb, interfere with or affect the ability of persons or businesses residing or located in the vicinity of the licensed premises to use their property in a reasonable manner; [1993, c. 730, §27 (AMD).]
- D. Repeated incidents of record of breaches of the peace, disorderly conduct, vandalism or other violations of law on or in the vicinity of the licensed premises and caused by persons patronizing or employed by the licensed premises; [1989, c. 592, §3 (AMD).]
- E. A violation of any provision of this Title; [2009, c. 81, §1 (AMD).]
- F. A determination by the municipal officers or county commissioners that the purpose of the application is to circumvent the provisions of section 601; and [2009, c. 81, §2 (AMD).]
- G. After September 1, 2010, server training, in a program certified by the bureau and required by local ordinance, has not been completed by individuals who serve alcoholic beverages. [2009, c. 81, §3 (NEW).]
[2009, c. 81, §§1-3 (AMD) .]

3. Appeal to bureau. Any applicant aggrieved by the decision of the municipal officers or county commissioners under this section may appeal to the bureau within 15 days of the receipt of the written decision of the municipal officers or county commissioners. The bureau shall hold a public hearing in the city, town or unincorporated place where the premises are situated. In acting on such an appeal, the bureau may consider all licensure requirements and findings referred to in subsection 2.

A. [1993, c. 730, §27 (RP).]

B. If the decision appealed from is an application denial, the bureau may issue the license only if it finds by clear and convincing evidence that the decision was without justifiable cause. [1993, c. 730, §27 (AMD) .]
[1995, c. 140, §6 (AMD) .]

4. No license to person who moved to obtain a license. [1987, c. 342, §32 (RP) .]

5. Appeal to District Court. Any person or governmental entity aggrieved by a bureau decision under this section may appeal the decision to the District Court within 30 days of receipt of the written decision of the bureau.

An applicant who files an appeal or who has an appeal pending shall pay the annual license fee the applicant would otherwise pay. Upon resolution of the appeal, if an applicant's license renewal is denied, the bureau shall refund the applicant the prorated amount of the unused license fee.

[1995, c. 140, §7 (AMD); 1999, c. 547, Pt. B, §78 (AMD); 1999, c. 547, Pt. B, §80 (AFF) .]

Please be sure to include the following with your application:

Completed the application and sign the form.

Signed check with correct license fee and filing fee.

Your local City or Towns signature(s) are on the forms.

Be sure to include your ROOM, FOOD and LIQUOR gross income for the year (if applicable).

Enclose diagram for all businesses, auxiliary locations, extended decks and storage areas.

Complete the Corporate Information sheet for all ownerships except sole proprietorships.

If you have any questions regarding your application please contact us at (207)624-7220.



Division of Alcoholic Beverages and Lottery
Operations
Division of Liquor Licensing and Enforcement

**Corporate Information Required for
Business Entities Who Are Licensees**

For Office Use Only:	
License #:	_____
SOS Checked:	_____
100% Yes	<input type="checkbox"/> No <input type="checkbox"/>

Questions 1 to 4 must match information on file with the Maine Secretary of State's office. If you have questions regarding this information, please call the Secretary of State's office at (207) 624-7752.

Please clearly complete this form in its entirety.

- Exact legal name: FALMOUTH PREMIUM CINEMAS LLC
- Doing Business As, if any: FLAGSHIP PREMIUM CINEMAS
- Date of filing with Secretary of State: 8/24/15 State in which you are formed: MAINE
- If not a Maine business entity, date on which you were authorized to transact business in the State of Maine:

- List the name and addresses for previous 5 years, birth dates, titles of officers, directors and list the percentage ownership: (attach additional sheets as needed)

NAME	ADDRESS (5 YEARS)	Date of Birth	TITLE	Ownership %
JOHN J. CROWLEY JR	39 CANON ROYAL DRIVE KEY WEST, FL 33040 SOUTH POINT DRIVE MIAMI BEACH, FL 33031	7/23/39	MEMBER	33 1/3
PAUL W. WENGER	11836 GONTRUM ROAD KINGSVILLE, MD 21087	7/8/64	MEMBER	33 1/3
MAINE CINEMA TRUST	55 CAMBRIDGE PARKWAY SUITE 200 CAMBRIDGE MA 02142	—	MEMBER	33 1/3

(Stock ownership in non-publicly traded companies must add up to 100%.)

- If Co-Op # of members: _____ (list primary officers in the above boxes)
- Is any principal person involved with the entity a law enforcement official?
Yes No If Yes, Name: _____ Agency: _____

8. Has any principal person involved in the entity ever been convicted of any violation of the law, other than minor traffic violations, in the United States?

Yes No

9. If Yes to Question 8, please complete the following: (attached additional sheets as needed)

Name: _____

Date of Conviction: _____

Offense: _____

Location of Conviction: _____

Disposition: _____

Signature:

Signature of Duly Authorized Person

Date

10/14/16

JANET OPPENDER
Print Name of Duly Authorized Person

Submit Completed Forms To:

Bureau of Alcoholic Beverages
Division of Liquor Licensing and Enforcement
8 State House Station, Augusta, Me 04333-0008 (Regular address)
10 Water Street, Hallowell, ME 04347 (Overnight address)
Telephone Inquiries: (207) 624-7220 Fax: (207) 287-3434
Email Inquiries: MaineLiquor@Maine.gov

Use a separate sheet of paper if necessary.

Name in Full (Print Clearly)	DOB	Place of Birth
PLEASE SEE ATTACHED		

Residence address on all of the above for previous 5 years (Limit answer to city & state)

10. Has/have applicant(s) or manager ever been convicted of any violation of the law, other than minor traffic violations, of any State of the United States? YES NO

Name: _____ Date of Conviction: _____

Offense: _____ Location: _____

Disposition: _____ (use additional sheet(s) if necessary)

11. Will any law enforcement official benefit financially either directly or indirectly in your license, if issued? Yes No If Yes, give name: _____

12. Has/have applicant(s) formerly held a Maine liquor license? YES NO

13. Does/do applicant(s) own the premises? Yes No If No give name and address of owner: MATT URNE FORESIDE PLACE LLC 5 MILK STREET 3RD FLOOR PORTLAND ME 04101

14. Describe in detail the premises to be licensed: (On Premise Diagram Required) LUXURY TEN SCREEN MOVIE THEATER W/SELF-SERVE SODA ALL DIGITAL PROJECTION SIGNAGE, ELECTRIC RECLINERS, KIOSKS FOR ONLINE TICKET REDEMPTION

15. Does/do applicant(s) have all the necessary permits required by the State Department of Human Services? YES NO Applied for: _____

16. What is the distance from the premises to the NEAREST school, school dormitory, church, chapel or parish house, measured from the main entrance of the premises to the main entrance of the school, school dormitory, church, chapel or parish house by the ordinary course of travel? 1.1 MILES Which of the above is nearest? SCHOOL

17. Have you received any assistance financially or otherwise (including any mortgages) from any source other than yourself in the establishment of your business? YES NO

If YES, give details: _____

The Division of Liquor Licensing & Enforcement is hereby authorized to obtain and examine all books, records and tax returns pertaining to the business, for which this liquor license is requested, and also such books, records and returns during the year in which any liquor license is in effect.

NOTE: "I understand that false statements made on this form are punishable by law. Knowingly supplying false information on this form is a Class D offense under the Criminal Code, punishable by confinement of up to one year or by monetary fine of up to \$2,000 or both."

Dated at: _____ on _____ 20____

[Signature]
Signature of Applicant or Corporate Officer(s)
JOHN J. CROWLEY
Print Name

Please sign in blue ink

[Signature]
Signature of Applicant or Corporate Officer(s)
PAUL WEXNER
Print Name

NAME, DOB & PLACE OF BIRTH (CITY,STATE), LAST 5 YEARS RESIDENCE (CITY,STATE) OF APPLICANTS,
MANAGERS AND BAR MANAGERS

John Crowley, 7/23/39 Somerville, MA	Key West, FL & Miami Beach, FL
Paul Wenger, 7/8/64 Baltimore, MD	Kingsville, MD
Ashley Taylor, 9/24/85 Portland, ME	Portland, ME & Westbrook, ME
Jason Byrd, 2/26/90 Portland, ME	Gorham, ME
Brianna Wing, 6/1/90 Portland, ME	South Portland, ME & Portland, ME
Seth Glidden, 7/29/86 Portland, ME	Westbrook, ME & Biddeford, ME
Trevor Richer, 5/24/92 Springvale, ME	Springvale, ME